



SNIP. SHEAR. THIN. HARVEST.

SHEARS & SNIPS
HYDROPONIC TOOLS
FLORAL SHEARS



ACCESSORIES



LEATHER SCABBARD FOR HAND PRUNERS AND FOLDING SAWS

AC 7220

- Top-grain leather construction
- Stitched and riveted for durability
- Belt clip and loops included
- Universal design fits most hand pruners and folding saws
- Pouch depth measures 5 in.
- Lifetime warranty



UNIVERSAL TOOL POUCH

AC 4510

- Wear resistant nylon construction
- Universal design fits hand pruners and folding saws
- Easy to carry using metal clip or belt loops
- Front pocket for sharpener storage
- Pouch depth measures 5 in.
- Lifetime warranty

Sharpener not included



CARBIDE SHARPENING TOOL

AC 8300

- Sharpens blades to increase cutting precision and extend life of the tool
- 5 in. super carbide file
- Non-slip grip
- Sharpen both sides of blade in 4 to 5 passes to remove metal burrs
- Lifetime warranty



GRASS SHEARS

ClassicCUT® SOD CUTTER AND GRASS SHEARS

GS 6750D

- MAXFORGED steel: most durable tools that stay sharper longer
- Professional cutting action cuts tough sod and ground cover
- Coated non-slip handles for enhanced comfort and control
- Resharpenable blades
- Lifetime warranty



REPLACEMENT PARTS AVAILABLE

- 6750-3** - Pivot Bolt and Nut
- 6200-5** - Spring
- 6000-43** - Clip and Eyelet

ComfortGEL® GRASS SHEARS

GS13760

- Precision-ground, high-carbon steel blades
- Chrome-plated finish on non-blade components for rust resistance
- Adjustable blade for multiple cutting angles: vertical, horizontal and edging
- Easy-to-set thumb lock helps ensure safety when not in use
- Lifetime warranty



GRASS SHEARS

GS 3750D

- Versatile three-position blade: vertical for edging, horizontal for trimming, and angled for hard-to-reach areas
- Precision-ground, high-carbon steel blades
- Chrome-plated finish
- Easy-to-set thumb lock
- Coated non-slip handles
- Lifetime warranty



HEDGE SHEARS

ClassicCUT® HEDGE SHEARS

HS15150 | 10 IN. BLADES
12-1/2 IN. STEEL HANDLES

- Blade designed for enhanced performance featuring limb notch for tough hedges
- Forged steel alloy blades are resharpenable for longer life
- Soft grip handle is contoured to comfortably fit various hand sizes
- Shock-absorbing integrated bumper
- Lightweight steel cord handles make repetitive cuts easy
- No-fail metal end cap
- Lifetime warranty

REPLACEMENT PARTS AVAILABLE

- 15150-40** - Bumper and Screw
- 7180-3** - Pivot Bolt and Nut



PrecisionCUT ALUMINUM HEDGE SHEARS

HS15340CC | 7-1/4 IN. BLADES
12-3/4 IN. ALUMINUM HANDLES

- Pointed steel blades for perfect cuts and topiary work
- Lightweight tool weighs less than 2 lbs. For less fatigue when trimming overhead
- Non-slip comfort grip
- Rubber bumpers prevent jarring during repetitive jobs
- Lifetime warranty



HEDGE SHEARS

SerratedBLADE HEDGE SHEARS

AH 6940 | 8-1/2 IN. BLADES
13 IN. ALUMINUM HANDLES

AH 6950 | 8-1/2 IN. BLADES
21 IN. ALUMINUM HANDLES

- Resharpenable, forged steel alloy blades
- Fully heat-treated for strength
- Serrated top blade and limb notch in lower blade
- Dual forged-in bumper cups with elastomer bumpers
- Lightweight, high-strength elliptical aluminum handles
- Lifetime warranty
- **REPLACEMENT PARTS AVAILABLE**
6900-3 - Pivot Bolt, Nut and Washer
6940-40 - Bumper



DualCUT HEDGE SHEARS

HS 7140 | 10 IN. BLADES
12-1/2 IN. STEEL HANDLES

- Enhanced performance with large cuts due to patented design - includes limb notch
- Easy to resharpen
- Comfortable steel handles with contoured soft grips fits various hand sizes
- Shock-absorbing integrated bumper
- No-fail metal end cap
- Lifetime warranty
- **REPLACEMENT PARTS AVAILABLE**
7180-3 - Pivot Bolt and Nut
7180-40 - Bumper with Screw

Patents U.S. D664,406, 8,910,386, Canada 2,775,512



LimbNOTCH BLADE HEDGE SHEARS

AH 6970 | 10-1/2 IN. BLADES
12-1/2 IN. ALUMINUM HANDLES

- Resharpenable forged steel alloy blades
- Fully heat-treated blade for strength
- Features limb notch for cutting larger branches
- Dual forged-in bumper cups with elastomer bumpers
- Lightweight, high-strength elliptical aluminum handles
- Lifetime warranty
- **REPLACEMENT PARTS AVAILABLE**
6900-3 - Pivot Bolt, Nut and Washer
6940-40 - Bumper



SerratedBLADE HEDGE SHEARS

HS 6920 | 8-1/2 IN. BLADES
9-1/2 IN. HARDWOOD HANDLES

HS 6930 | 8-1/2 IN. BLADES
20 IN. HARDWOOD HANDLES

- Resharpenable, forged steel alloy blades
- Fully heat-treated for strength
- Serrated top blade and limb notch in lower blade
- ShockSTOP bumper
- Bolted-on hardwood handles with non-slip grips
- Lifetime warranty
- **REPLACEMENT PARTS AVAILABLE**
6920-4 - Handle - HS 6920
6930-4 - Handle - HS 6930
6900-3 - Pivot Bolt, Nut and Washer
6900-40 - Bumper
6300-41 - Handle - Bolt and Nut



ExtendableREACH HEDGE SHEARS

HS 3950 | 10 IN. BLADES
3 IN. - 20 IN. STEEL HANDLES

- Lightweight steel handles with comfort grips extend from 13 in. to 20 in.
- Forged, high-carbon steel blades for durability and strength
- Precision-made pivot bolt provides smooth cutting action
- ShockSTOP bumper reduces arm and shoulder fatigue
- Lifetime warranty



ResharpenableBLADE HEDGE SHEARS

HS 6960 | 10 IN. BLADES
9-1/4 IN. HARDWOOD HANDLES

- Resharpenable, forged steel alloy blades
- Fully heat-treated for strength
- Limb notch
- ShockSTOP bumper
- Bolted-on hardwood handles, comfortable non-slip grips
- Lifetime warranty
- **REPLACEMENT PARTS AVAILABLE**
6920-4 - Handle
6900-3 - Pivot Bolt, Nut and Washer
6900-40 - Bumper
6300-41 - Handle - Bolt and Nut



HEDGE SHEARS



DualLINK

Boosted power and reduced effort unite through *DualLINK* tools, that utilize a dual compound lever designed for both engaged gardeners and landscapers searching for ease-of-cut.

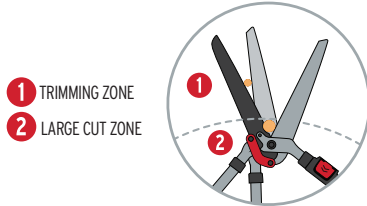

DualLINK with *ComfortGEL*[®] HEDGE SHEARS HS 4244 | 9-3/4 IN. BLADES 14 IN. HANDLES

- Minimize cutting effort with DualLINK linkage - open handles less to cut more
- Steel handle with *ComfortGEL*[®] grip
- Less fatigue with ShockGUARD[®] bumper system
- Lifetime warranty

U.S. Patent D703,498



ComfortGEL[®] EXTENDABLE HEDGE SHEARS HS 3344 | 9 IN. BLADES 16-3/4 IN. - 24-5/8 IN. HANDLES

- Extended reach for precise cutting in large hedges
- ShockGUARD[®] bumper system reduces shock to arms after cutting
- *ComfortGEL*[®] grip for lasting comfort and control
- Lifetime warranty



HEDGE SHEARS HS 3911 | 8-1/4 IN. BLADES HARDWOOD HANDLES

- Limb notch for cutting larger branches
- Resharpenable, forged steel alloy blades
- Fully heat-treated for strength
- MAXFORGED steel: most durable tools that stay sharper longer
- Lifetime warranty
- **REPLACEMENT PARTS AVAILABLE**
3911-4 - Handle
6900-3 - Pivot Bolt, Nut and Washer



DualLINK with *ComfortGEL*[®] HEDGE SHEARS HS 4344 | 9-3/4 IN. BLADES 6-3/4 IN. - 24-5/8 IN. HANDLES

- DualLINK compound cutting action magnifies input force
- Extended reach for precise cutting in large hedges
- ShockGUARD[®] bumper system reduces shock to arms after cutting
- *ComfortGEL*[®] grip for lasting comfort and control
- Lifetime warranty

U.S. Patent D703,498 and D712,230



YardEssentials HEDGE SHEARS HS11109 | 8-3/4 IN. BLADES 11-1/2 IN. HANDLES

- Extended reach for precise cutting in large hedges
- Nonstick coating on blades minimizes friction
- Reduced fatigue in hands and shoulders due to integral bumper system
- Lifetime warranty



ComfortGEL[®] HEDGE SHEARS HS 3244 | 9 IN. BLADES | 13 IN. HANDLES

- Lightweight steel handles with comfort grip
- Specially coated non-stick blades provide maximum cutting
- Reduced hand fatigue with ShockGUARD[®] bumper system
- Maximize comfort and control with soft, ergonomically shaped grips
- Lifetime warranty



VALUE HEDGE SHEARS

COMPOUND ACTION HEDGE SHEARS AH 4220 | 9 IN. BLADES | 11-1/2 IN. HANDLES

- Compound action multiplies your cutting power
- Serrated edge to hold materials in place while cutting
- PTFE non-stick coated bottom blade
- Lightweight aluminum handles with plastic grip
- 1-year warranty

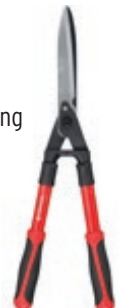

SHEARS & SNIPS



CITRUS SHEARS AG 5020

- Designed for rapid, high-volume lemon and citrus harvesting
- Drop-forged steel alloy construction with resharpenable blades
- Rounded tips help prevent damaged fruit
- 2 blade design for less interference during harvesting
- Non-slip grips
- Includes synthetic strap
- Lifetime warranty



ORANGE AND APPLE BYPASS SHEARS AG 5060

- Designed for rapid, high-volume orange, grapefruit and apple harvesting
- Two-blade design for less interference during harvesting
- Rounded tips help prevent fruit damage and maximize safety
- Forged alloy steel construction with resharpenable blades
- Cushioned, non-slip grips
- Lifetime warranty
- **REPLACEMENT PARTS AVAILABLE**
4300-3 - Pivot Bolt and Nut
5050-5 - Spring
5060-42 - Synthetic Strap

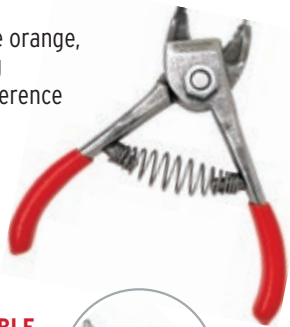

SYNTHETIC STRAP 5060-42

- Use with AG 5060, AG 5050, AG 5040 or AG 5010



Since the late 1920s, when other manufacturers were settling for stamped or cast tools, Corona® has been using high-quality forged steel to deliver superior performance and reliability. Generations later, these classically designed agricultural shears and snips are shearing California grape vines, pruning lemon, orange and avocado trees in the Southwest, apple trees in the Northwest, Midwest and East, while clipping, plucking and shaping landscapes around the world.

ORANGE AND APPLE ANVIL SHEARS AG 5050

- Designed for rapid, high-volume orange, grapefruit and apple harvesting
- Specially designed to sever fruit cleanly from fruiting spur
- Drop-forged steel alloy construction with resharpenable blades
- Custom-ground cutting edges and balanced spring design for fast, precise action
- Includes leather strap
- Lifetime warranty
- **REPLACEMENT PARTS AVAILABLE**
4300-3 - Pivot Bolt and Nut
5050-5 - Spring



AVOCADO SHEARS AG 5040

- Custom-ground cutting edges and balanced spring for high-volume cutting
- Cushioned, non-slip grips for safe and comfortable all-day use
- Forged alloy steel construction for superior strength
- Rounded tips help prevent fruit damage and maximize safety
- Built-in spring reliably opens blade after each cut
- Resharpenable blades
- Lifetime warranty
- **REPLACEMENT PARTS AVAILABLE**
4300-3 - Pivot Bolt and Nut
5050-5 - Spring
5060-42 - Synthetic Strap



LEMON SHEARS AG 5010

- Designed for rapid, high-volume lemon and lime harvesting
- Rounded tips help prevent damaged fruit
- Drop-forged steel alloy construction with resharpenable blades
- Rounded tips help prevent damaged fruit
- Close-tolerance pivot bolt
- Includes leather strap
- Lifetime warranty
- **REPLACEMENT PARTS AVAILABLE**
4300-3 - Pivot Bolt and Nut
5010-5 - Spring
5060-42 - Synthetic Strap



SHORT STRAIGHT SNIPS

AG 4910SS | 1 IN. STAINLESS STEEL BLADES

- Short, straight, blunt-nosed blade for a wide range of applications
- Corrosion-resistant stainless steel blades prevent rusting, are easier to clean and reduce germ build-up
- Unobtrusive leather strap lock
- Lifetime warranty



SHORT CURVED SNIPS

AG 4920SS | 1 IN. STAINLESS STEEL BLADES

- For harvesting apples, pitted fruits and berries
- Corrosion-resistant stainless steel blades are easy to clean and reduce germ build-up
- Unobtrusive leather strap lock
- Lifetime warranty



LONG STRAIGHT SNIPS

AG 4930SS | 1-3/4 IN. STAINLESS STEEL BLADES

- Long, straight, pointed blades are ideal for a wide range of applications
- Corrosion-resistant stainless steel blades are easy to clean and reduce germ build-up
- Slim, lightweight grips
- Unobtrusive attached leather strap
- Lifetime warranty



LONG STRAIGHT SNIPS

AG 4930 | 1-3/4 IN. BLADES

- Long, straight, pointed blades are ideal for a wide range of applications
- Forged tempered steel for superior strength
- Coated blades, spring and handle to prevent rust
- Unobtrusive attached leather strap
- Slim, lightweight grips for comfortable cutting in tight spaces
- Resharpenable blades
- Lifetime warranty
- **REPLACEMENT PARTS AVAILABLE**
4900-5 - Spring



LONG CURVED SNIPS

AG 4940SS | 1-3/4 IN. STAINLESS STEEL BLADES

- Long, curved, pointed blades are specifically made for picking and field-dressing grape bunches
- Corrosion-resistant stainless steel blades are easy to clean and reduce germ build-up
- Slim, lightweight grips
- Leather strap lock keeps gardening snips safely closed
- Lifetime warranty



LONG CURVED SNIPS

AG 4940 | 1-3/4 IN. BLADES

- Long, curved, pointed blades are specifically made for picking and field-dressing grape bunches
- Fully heat-treated steel blades for strength
- Coated blades, spring and handle to prevent rust
- Lifetime warranty
- **REPLACEMENT PARTS AVAILABLE**
4900-5 - Spring



HYDROPONIC TOOLS

HYDROPONIC FINGER MICRO SNIPS

FS 4110

- Sharp, precision blades designed for tiny cuts
- Corrosion-resistant stainless steel blades prevent rust
- ABS plastic handle is lightweight, and durable
- Large, ergonomic finger hole for maximum comfort
- Built-in spring reliably opens blade after each cut
- Push-button thumb lock is conveniently located
- Lifetime warranty



HYDROPONIC MICRO SNIPS

FS 4120 | 2-5/16 IN. DOUBLE-BEVELED TAPERED TIP BLADES

- Corrosion-resistant stainless steel blades prevent rust
- Resharpenable blades for long-lasting performance
- Durable, soft-touch handles for lightweight comfort
- Heavy-duty spring for reliable performance with high-volume cuts
- Built for left- and right-handed use
- Lifetime warranty



HYDROPONIC SCISSORS

FS 4130 | 2 IN. BLADES

- Stainless steel blades with double beveled tapered tips for precision cuts
- Durable handle offers lightweight comfort and performance
- Handle and blades can be sterilized to limit cross contamination
- Lifetime warranty



FLORAL SHEARS

THINNING SHEARS

FS 4350 | 1-3/4 IN. BLADES

- Long, straight, rounded blades are ideal for a wide range of applications
- Corrosion-resistant blades prevent rust, reduce germs
- Forged alloy steel construction for superior strength
- Cushioned, lightweight grips
- Leather strap lock keeps garden snips safely closed
- Built for left- and right-handed use
- Lifetime warranty
- **REPLACEMENT PARTS AVAILABLE**
- 4300-3 - Pivot Bolt and Nut
- 4300-5 - Spring
- 6000-43 - Clip and Eyelet





ErgoCUT
DEAD HEADER
FS14630

- Ergonomic design reduces stress on hands and wrists
- Finger loop provides improved control of pruning tool
- High-carbon steel blades provide lasting sharpness
- Easy-release secure blade lock for safe use and storage
- Lifetime warranty



ComfortGEL®
FLORAL SCISSORS
FS 3394 | 3 IN. BLADES

- Serrated blades are designed for cutting and deadheading
- Detachable, stainless steel blades are corrosion-resistant
- Resharpenable blades for long-lasting performance
- Lifetime warranty



ComfortGEL®
FLORAL SNIPS
FS 3204 | 1-3/4 IN. BLADES

- Fully heat-treated blades maintain sharpness
- Volute spring resists dirt build-up and clogging
- Thorn stripper for stems up to 3/8 in. diameter
- Maximize comfort and control with soft, ergonomically shaped grip
- Lifetime warranty



PRECISION SCISSORS
FS14530 | 1-3/4 IN. BLADES

- Fine, pointed blades reach and isolate specific stems
- Large, open-handle grips for comfort and control
- High-carbon steel blades retain a razor-sharp edge
- Lightweight, compact design for floral arranging
- Elongated shape for hard to reach trimming
- Lifetime warranty



YardEssentials
MINI FLORAL SNIPS
FS43623

- Specially shaped blade designed to help isolate leaf or stems
- Precision control for quick herb and flower harvesting
- Rust-resistant stainless steel blades
- Non-slip comfort grips
- Easy-release secure blade lock
- Lifetime warranty



ComfortGEL®
MICRO SNIPS
FS 3214D | 1-3/4 IN. BLADES

- Long, double-beveled blades with tapered tips
- Corrosion-resistant stainless steel blades
- Resharpenable blades for long-lasting performance
- Heavy-duty spring for reliable performance with high-volume cuts
- Built for left and right-handed use
- Lifetime warranty



YardEssentials
MINI FLORAL SNIPS
FS43624

- Pack of 12: 3 red, 3 black, 3 green, 3 yellow
- Easy to spot colors
- Lifetime warranty

